

INSTALLATION INSTRUCTIONS

HYMAX[®]

Repair the past. Connect the future.

KRAUSZ is the creator of HYMAX

DISMANTLING JOINT

(2" - 24")

INSTALLATION OF THE COUPLING:

4

PLACE NUTS

Place the outer nuts on the other side of the flange.

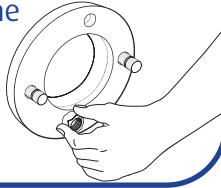

5

INSERT GASKET

Insert the second gasket (not provided) between the two flanges.

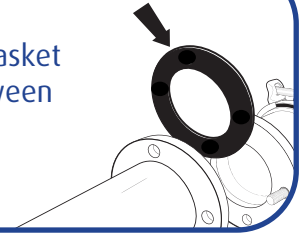

6

ATTACH THE DISMANTLING BOLTS.

Expand the Dismantling Joint until both flanges are flush.

Insert the second flange gasket into position.

Attach the Dismantling Joint to the opposite mating flange in your system and fasten together with flange bolts.

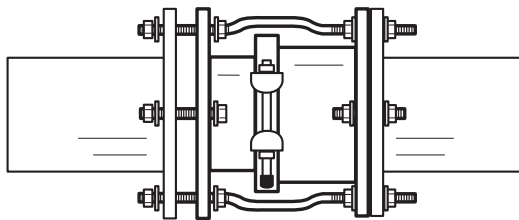

7

CONNECT

Insert additional bolts and nuts through the remaining holes in the flanges to tighten the dismantling joint to both flanged products.

Tighten the INNER nuts against the flanges on both sides.

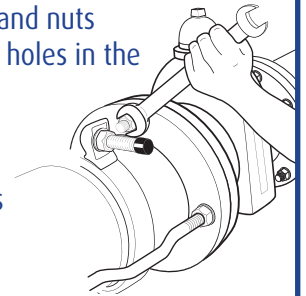

NOTE: Without the tie-rods in place, the product is NOT RESTRAINED.

Each tie rod will have a total of 4 nuts when assembled. Insert additional bolts and nuts through the remaining holes in the flanges to tighten the Dismantling Joint to both flanged products.

8

TIGHTEN

In sizes 2"-12": Tighten the bolt on the end ring.

In sizes 14"-24": Tighten the bolts evenly on each side of the end ring.

Tighten the end ring bolts to the right torque as indicated on the label.

NOTE: Use of torque wrench is mandatory. The torque wrench will verify the proper torque has been achieved..

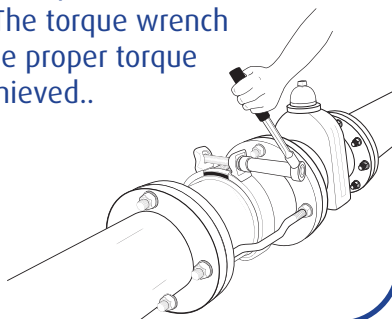

9

RECHARGE

Recharge the line and check for leaks. If any leakage across the seal end is evident, reduce the pressure in the line and increase the labeled torque of the end ring bolts by up to 50%.

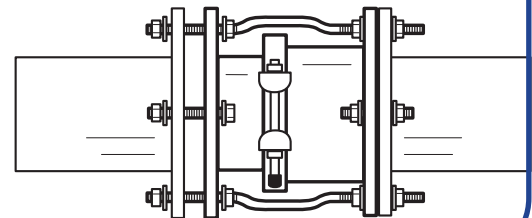

HYMAX[®]

Repair the past. Connect the future.

 **KRAUSZ** is the creator of HYMAX