

REVISIONS

REV.	DESCRIPTION	ECO	DRAWN	APPROVED	DATE
F1	Adding data		Galina E.	Tzah G.	19/08/2019

SECTION A-A

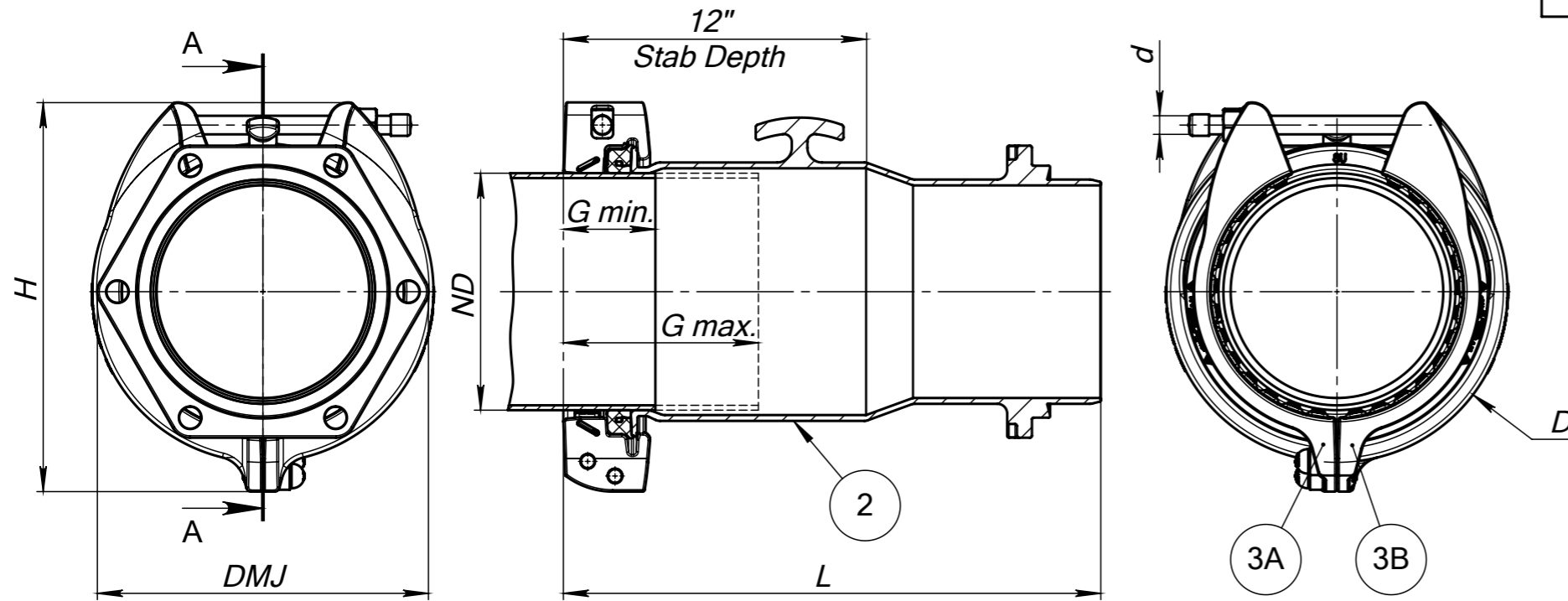

Material information:

- 1) HYMAX GRIP meets and exceeds standards: AWWA C219, NSF-61 and NSF-372.
- 2) Body - Ductile iron casting ASTM A536 grade 65-45-12. MJ adaptor compatible with: ANSI / AWWA C111 / A21.11-12.
- 3) End Rings 3" - Couple of parts( A-part and B-part). made of Cast Steel ASTM A216 WCB.
- 4) End Rings 4"-12" - Couple of parts( A-part and B-part). made of Ductile iron casting ASTM A536 grade 60-40-18.
- 5) Gaskets - EPDM compounded for water and sewerage, meets international standards for contact with drinking water. Working Temperature: for continuous operations: -20 °F up to +180 °F. for short time operations: up to +215 °F.
- 6) Bolts, Nuts and Washers - AISI 304 stainless steel. Rolled thread and anti galling coating.
- 7) Spherical spacers - AISI 304 stainless steel.
- 8) Bridge - AISI 304 stainless steel.
- 9) Gripping Teeth : 3" -Fe2Ni, hardened and coated with Zinc-Nickel TL 244 Ofl-r673. 4"-12" - AISI420, hardened and coated with Zinc Flake System.
- 10) Coating - 100% Fusion bonded epoxy for enhanced corrosion protection. Average thickness 14 Mil. Working Temperature: above ground applications: up to +125 °F. under ground applications: up to +150 °F.

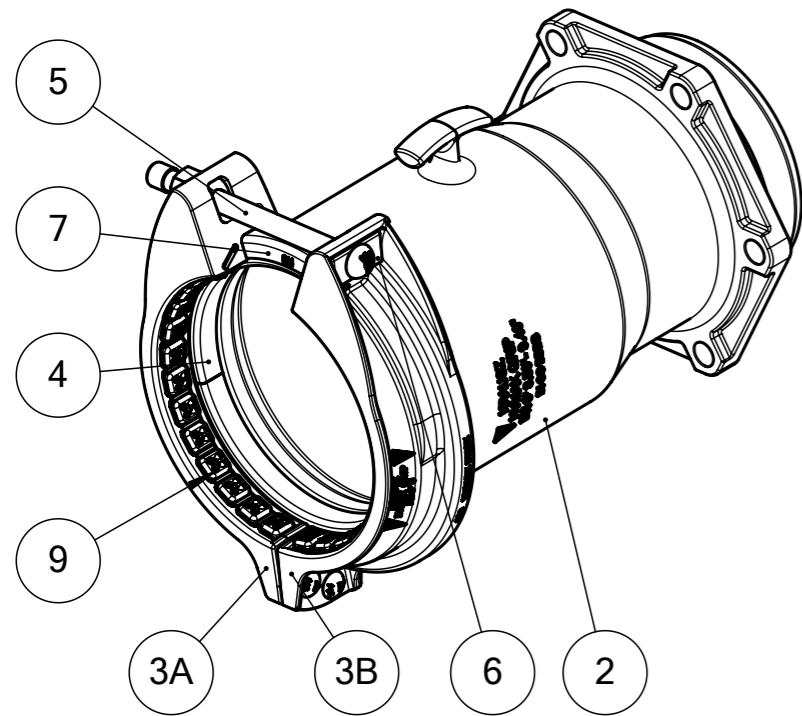

**NOT FOR PRODUCTION**

Krausz Part Number	ND (inch)	Overall Range (inch)	Befor removal the inner layer (inch)	After removal the inner layer (inch)	DMJ (inch)	L (inch)	D (inch)	H (inch)	G Max (inch)	Bolts Qty.-Size d (inch)	Torque (ft-lbs)	Approx Weight (Lb)
791-56-03080-16	3	3.15-4.17	3.15-3.74	3.70-4.17	7.61	21.65	6.93	9.06	5.7	1 - M14	50	29.17
791-56-04111-16	4	4.40-5.10	X	X	9.22	21.65	8.7	10.6	7.5	1 - 5/8"	90	39.1
791-56-06165-16	6	6.50-7.20	X	X	11.12	21.65	10.9	12.9	8.2	1 - 5/8"	110	54.5
791-56-08216-16	8	8.50-9.40	X	X	13.36	21.65	13.8	15.7	6.2	1 - 3/4"	200	79.3
791-56-10270-16	10	10.65-11.55	X	X	15.61	21.65	16.2	18.2	6.3	1 - 3/4"	200	99.74
791-56-12322-16	12	12.68-13.39	X	X	17.88	21.65	17.4	19.8	7.5	1 - 3/4"	200	114.57

Product performance	
Dynamic deflection	up to 4°
G - Min. pipe Insertion	3.6"
G - Max. pipe Insertion	see table*
Maximum offset for misaligned pipe	0.12"
Maximum out of roundness	0.16"
MAX ΔT for HDPE pipes SDR9	see table*
Working Pressure (for HDPE pipes see table*)	232 PSI
Rated Pressure (for HDPE pipes see table*)	350 PSI
Vacuum Test	12 PSI



*HDPE Pipe IPS+DIS			
ND (inch)	Working Pressure (PSI)	Rated Pressure (PSI)	max ΔT for SDR9 (°F)
3	232	350	85
4	232	350	85
6	232	350	85
8	193	290	50
10	163	245	50
12	155	232	35

Weight: See Table		Part Name: HYMAX GRIP Cut-in-Sleeve MJ 3"-12"		Scale
Design	Date: 02.08.2018	Name: Ryvzh	Catalog No. SD791-56-01	DO NOT SCALE DRAWING
Check	09/10/2018	Galina E.	Drawing No. SD791-56-01	
Appr.	09/10/2018	Tzah Gr.		Sheet 1 of 1
Confidential Information. All rights reserved to Krausz Industries Ltd. This document may not be copied, reproduced, displayed, modified or used in any way, whether in whole or in part, without the express prior written consent of Krausz Industries Ltd.			Size A3	